

Courses & Dists down Tuscarora.
 N 47 E 10
 N 9 W 15 1/4
 N 36 E 30
 N 4 W 32
 N 77 1/2 W 27
 N 6 E 11 1/4
 N 41 1/2 E 52
 N 55 E 34 1/2
 N 33 1/2 E 14 1/2
 226 1/2

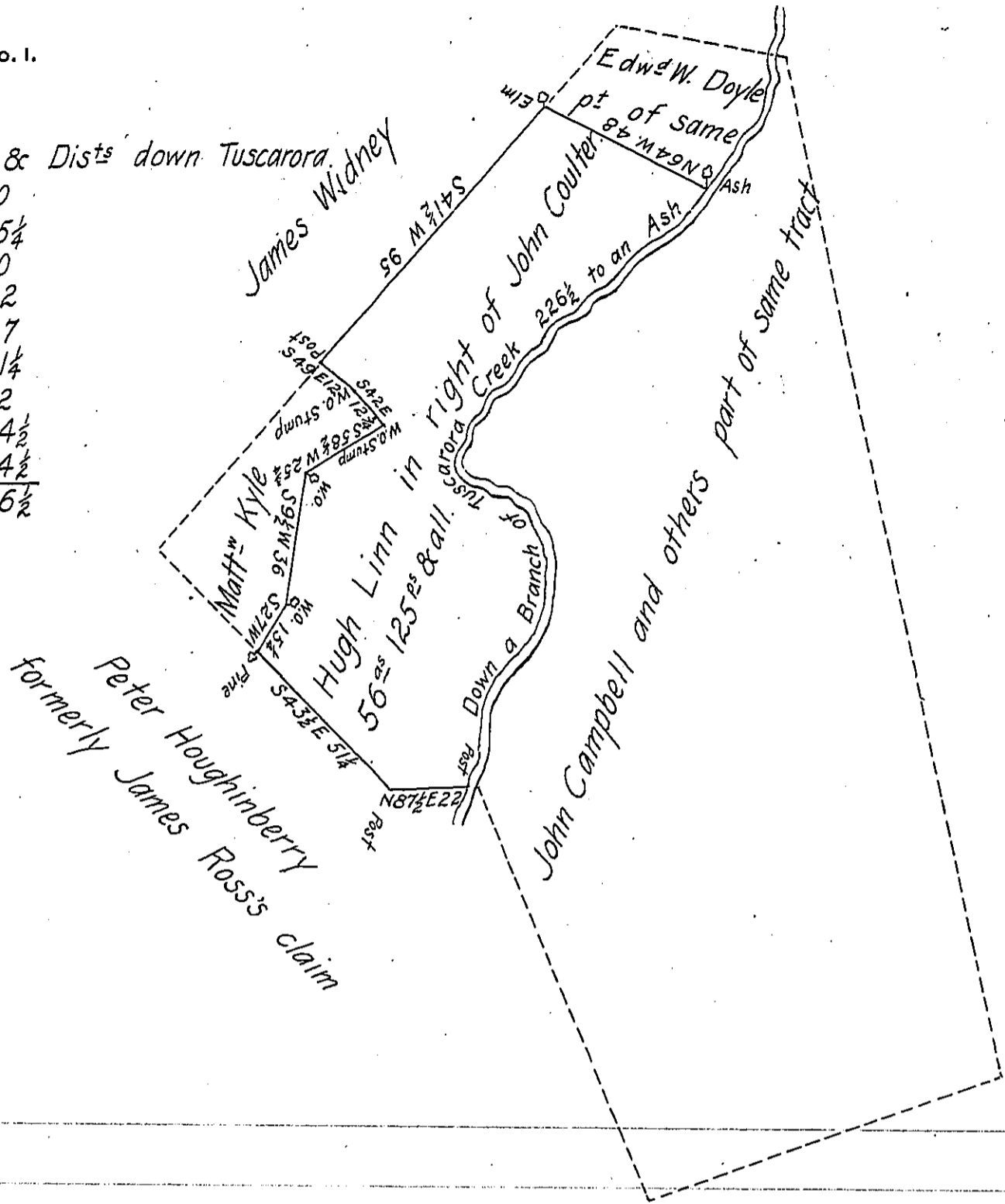

The above described Tract of fifty six Acres, one hundred and twenty five perches and allowance of six per cent for Roads & c is part of a larger tract of 249^{as} & allowance, situate in Fannet- Township ~~Township~~ (formerly Cumberland) now Franklin County, which was Surveyed the 11th of June 1763 in pursuance of a Warrant, Granted to John Coulter, bearing date the 30th Dec^r 1762, Surveyed & laid off the above part the 8th of May 1822.

W^m S. Davis D.S.

To Samuel Cochran Esquire
 Surveyor Gen^l of Pennsylvania }

IN TESTIMONY that the above is a copy of the original remaining on file in the Department of Internal Affairs of Pennsylvania, made conformably to an Act of Assembly approved the 16th day of February, 1833, I have hereunto set my Hand and caused the Seal of said Department to be affixed at Harrisburg, this fourth day of September 1906.

Isaac D. Rawson
 Secretary of Internal Affairs.